

Mounting Instruction

OBD-Saver

intended for the following Vehicles:

BMW – Version B

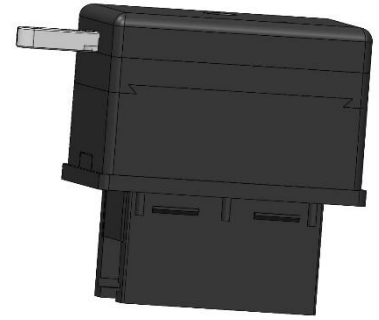

Description:

The OBD Saver disables effectively every access to ECUs via OBD – Interface (e.g. electronic immobilizer). The OBD – interface is locked with the OBD Saver. Thus connecting any device to the OBD interface is impossible and the connection to the car their fore denied.

When locked by the OBD Saver your car is protected very effectively. The control unit which controls the ignition of your car cannot be deactivated via OBD. From this time on your car will only start with the original ignition keys!

Scope of Delivery :

- 1x OBD-Saver enclosure including the lock
- 2x keys
- 1x allen wrench 2,5
- 3x allen screw M3 + 1x spare screw + 4x Phillips-tip screws
- 2x window sticker

Mounting :

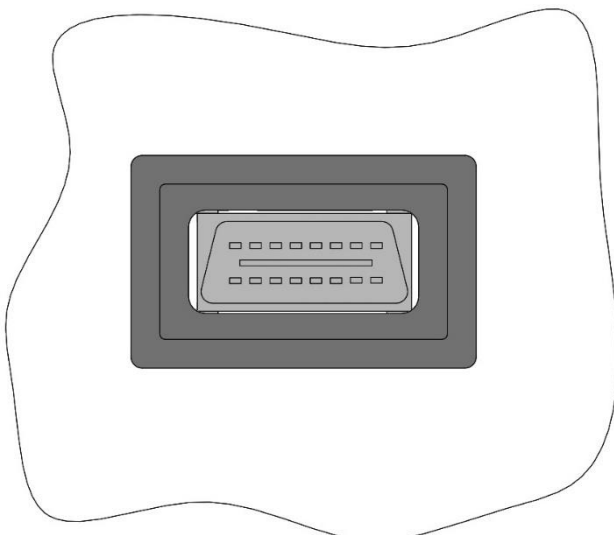

- pull out the original housing.
(original housing might be a little bit tough to remove).

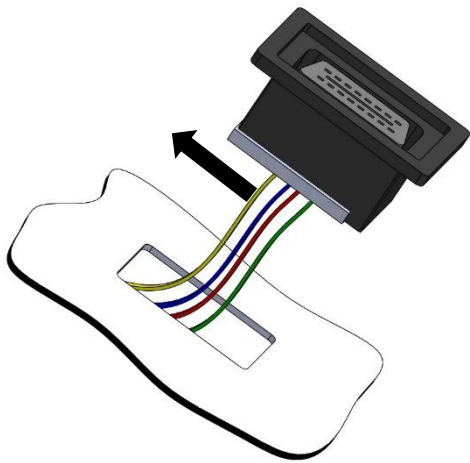

- Push the bracket located on the back of the socket jack to the side
- Now pull out the socket jack (remove the old housing).

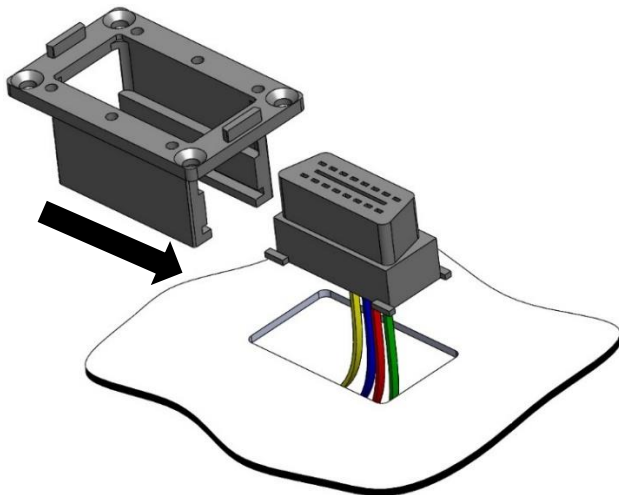

- push the provided OBD-Saver housing onto the socket jack from the side
- Fix it with the provided Phillips-tip screws
The screws have to be fully screwed in!
!!! Important !!! don't overtighten the screws!



- Plug in the lock and fix it with the provided M3 screws

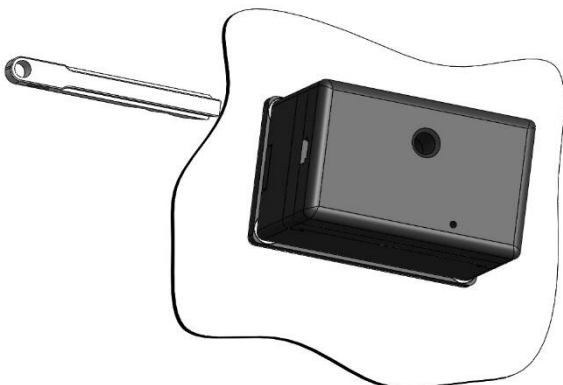

- Close the OBD-Saver and remove the key